

QUARTZ

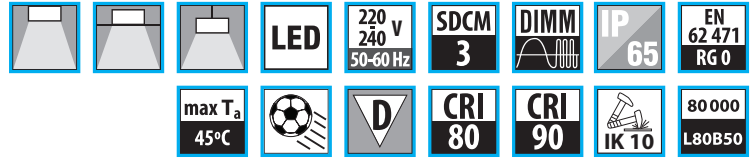

η_{ef} (lm/W)
149-170



QUARTZ4M

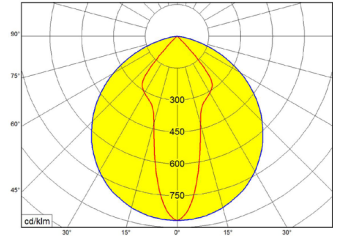

QUARTZ

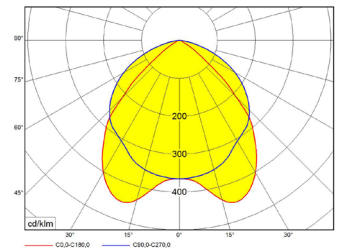

QUARTZW

LED high-bays

Body:
White painted (RAL9003) metal sheet

Optic:
Highly polished reflectors made of MIRO® aluminium
QUARTZ... narrow beam 35°
QUARTZ W... wide beam 115°

Cover:
Clear hardened glass (standard)
PC – clear polycarbonate, mechanical resistance IK10
PCO – opal polycarbonate, mechanical resistance IK10
KN – microprismatic PMMA
PCN – mikroprismatic PC cover (certificated for sporthalls according to DIN VDE 0710-13)

Application:
Supermarkets, assembly halls, stocks, etc. – as an alternative for discharge or fluorescent lamp luminaires

Assembly:
Pendant / surface installation.
Fixtures are equipped with 4 snap hooks for easy hanging by chains or ropes with eyelet.
To connect to the power are fittings equipped with cable with IP65 connector.
IK10 – available version with higher resistance, with cover PC, PCO or PCN

Accessories:
MONTSET - a holder for surface assembly
VESTRAM - a holder for recessed installation of QUARTZ 4S
PIR - sensor for QUARTZ

Variants:
V1 = luminaire with driver in gear box
V2 = luminaire with driver without gear box
V4 = luminaire with low current driver in gear box

2200	2700	3000	4000	5700	6500	MIX	RGB	
✗	✗	○	●	○	○	✗	✗	✗
●	✗	○	○	✗	○	✗	✗	●

● default ○ optional ✗ not possible

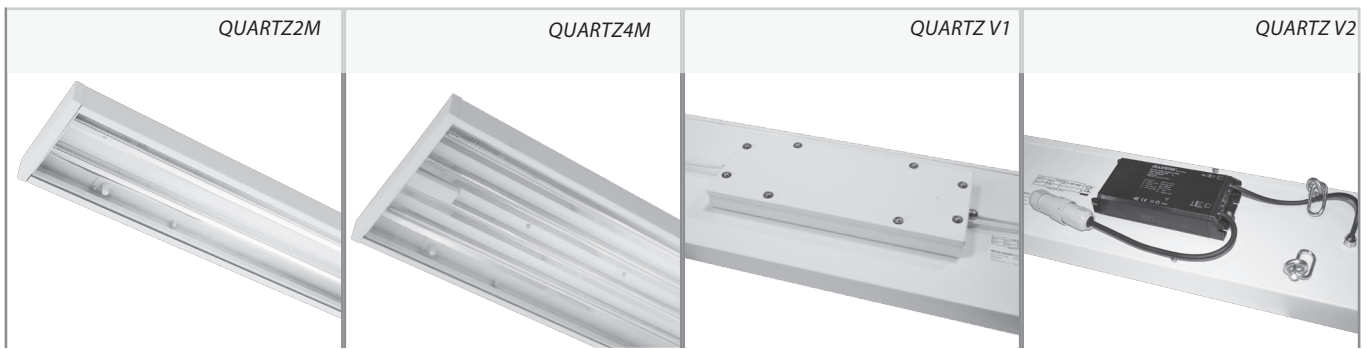

Codes: QUA2M4V1/2100ND

<p>QUA</p> <p>Luminaire type: QUA - narrow beam QUAW - wide beam</p>	<p>2</p> <p>Nr of lighting strips</p>	<p>M</p> <p>Body length S = 600 mm M = 1200 mm</p>	<p>4</p> <p>Color temperature: 3 = 3000K, 4 = 4000K 5 = 5700K</p>	<p>PC</p> <p>Cover type clear glass PC - clear polycarbonate PCO - opal polycarbonate KN - microprismatic-PMMA PCN - microprismatic cover</p>	<p>V1</p> <p>Insulation class V1 class I V2 class II</p>	<p>/2100ND</p> <p>Driver type: ND - no dimmable DALI - dimmable DALI</p>
--	---------------------------------------	--	---	---	--	--

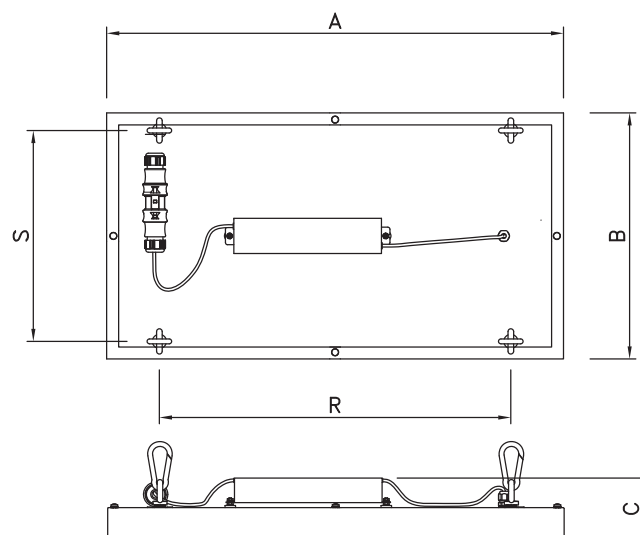

Dimensional table QUARTZ

QUARTZ	A	B	C	R	S	kg
QUARTZ 2S, QUARTZW 2S	655	197	90	500	140	5
QUARTZ 4S, QUARTZW 4S		357			300	7
QUARTZ 2M, QUARTZW 2M	1224	197		940	140	7
QUARTZ 4M, QUARTZW 4M		357			300	13
QUARTZ 6M, QUARTZW 6M		507			450	18

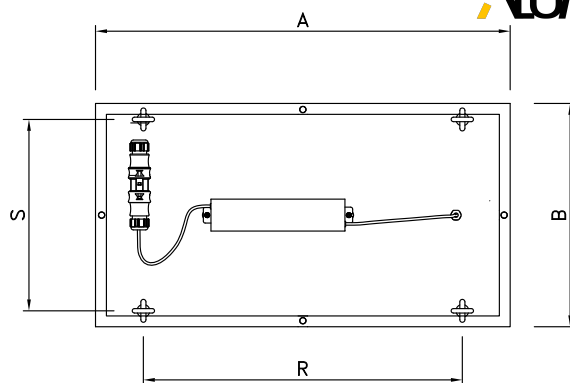
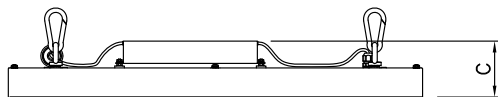

QUARTZ performance tables

QUARTZ	W	lm			
			PC	KN	PCN
QUARTZ 2S /1050	49	7300	7100	6900	5250
QUARTZ 4S /1400	61	10000	9500	8800	7900
QUARTZ 4S /2100	92	14500	14000	13500	11400
QUARTZ 2M /1400	61	10 000	9 500	8 800	7900
QUARTZ 2M /2100	92	14 500	14 000	13 500	11400
QUARTZ 4M /2800	125	20 000	19 400	18 800	15600
QUARTZ 4M /4200	182	29 500	28 800	27 600	22700
QUARTZ 6M /2100	278	44 000	X	X	X

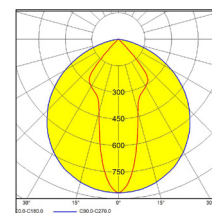

QUARTZ PC

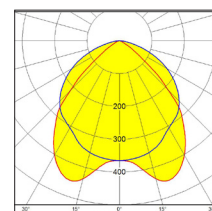

QUARTZW PC

QUARTZW	W	lm		
			PC	PCO
QUARTZW 2S /1050	49	7400	7200	6000
QUARTZW 4S /1400	61	10400	10000	8400
QUARTZW 4S /2100	92	15000	14500	12000
QUARTZW 2M /1400	61	10 400	10 000	8 400
QUARTZW 2M /2100	92	15 000	14 500	12 000
QUARTZW 4M /2800	125	20 500	19 900	16 700
QUARTZW 4M /4200	182	30 000	29 100	24 000
QUARTZW 6M /2100	278	45 000	X	X

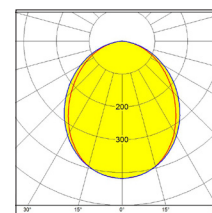

QUARTZW PCO

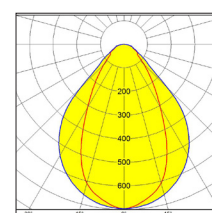

QUARTZ KN

QUARTZ V4	W	lm				
			PC	PCO	KN	PCN
QUARTZ 2M V4 /600	87	13 000	12 500	X	12000	10500
QUARTZ 4M V4 /1200	173	26 000	25 200	X	24000	21000

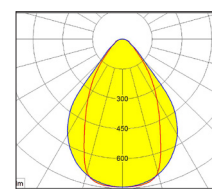

QUARTZ PCN

QUARTZW V4	W	lm				
			PC	PCO	KN	PCN
QUARTZW 2M V4 /600	87	13 500	13 000	10 800	X	X
QUARTZW 4M V4 /1200	173	27 000	26 200	22 000	X	X

lm - luminaire light output

QUARTZ – ACCESSORIES

MONTSET

Set of holders for surface assembly of QUARTZ.

White painted steel profile

Mounting to the body of the luminaire in place eyebolts.

Distance between the fitting and the ceiling is 80 mm

	X	Y	for fitting
MONTSET2	940	60	QUARTZ 2M
	500	60	QUARTZ 2S
MONTSET4	940	220	QUARTZ 4M
	500	220	QUARTZ 4S

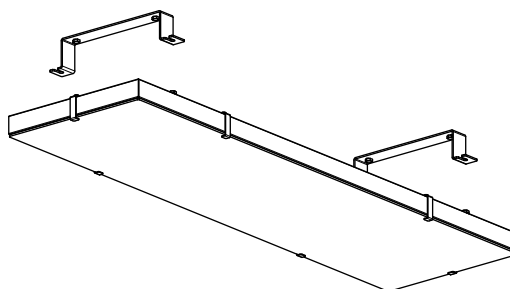
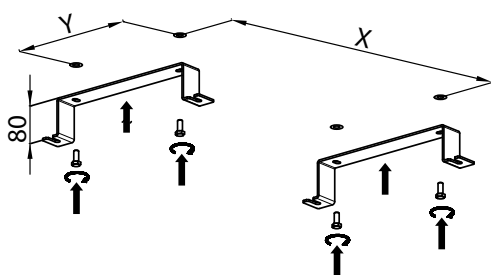

VESTRAM

Frame for recessed installation of QUARTZ into a ceiling

White painted metal sheet

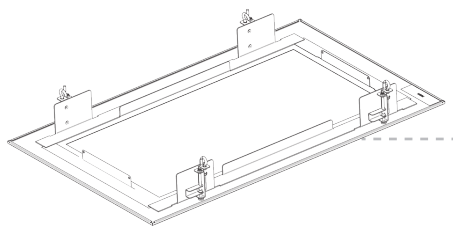

VESTRAM

	A	B	C	
VESTRAM/2S	800	340	110	670x310
VESTRAM/4S	800	500	110	670x470
VESTRAM/2M	1270	340	110	1240x310
VESTRAM/4M	1270	500	110	1240x470

PIR

Microwave sensor for QUARTZ

This sensor is a motion switch, which turns on the light on detection of people movement, and turns off after a pre-selected hold-time when there is no people around. A sensor is also built-in to prevent the light switching on when there is sufficient natural light.

IP65

Set included assembly holder and cables with connectors

Settings after installation with remote controller PIR/RC or with DIP switches.

Variants:

PIR/2M

PIR/4M

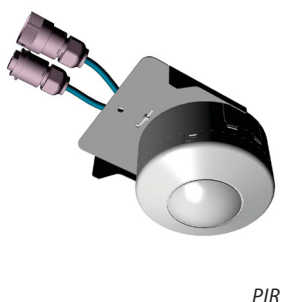
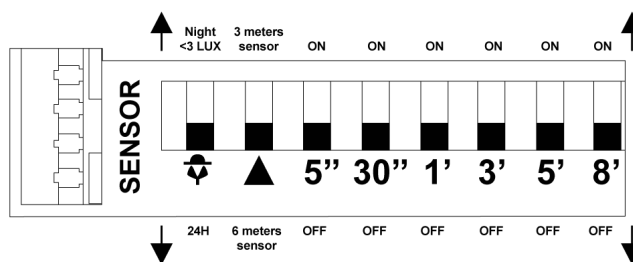

PIR

